

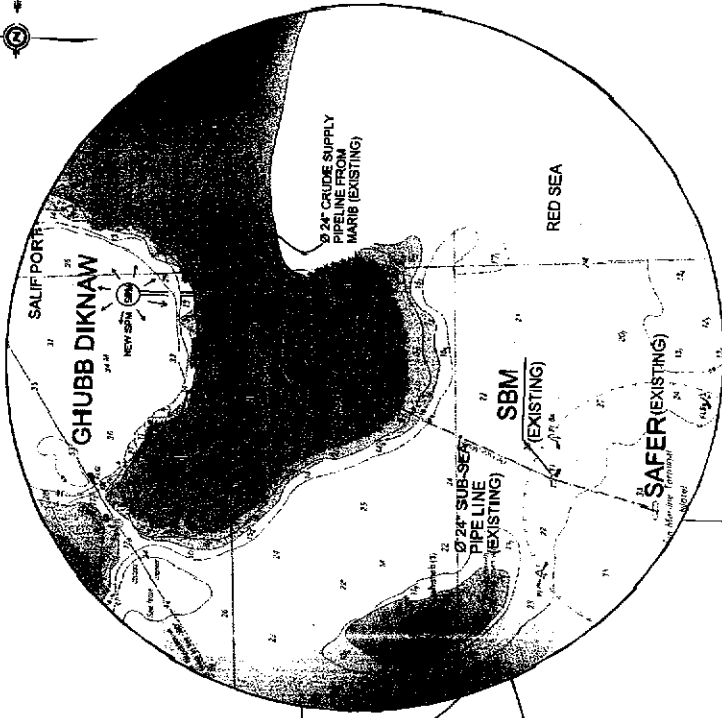

DRAWINGS

SAFER Saudi Arabia Refining and Production Operations Company (SREPPOC)
 ENGINEERING AND CONSTRUCTION DEPT
 RAS ISSA CRUDE OIL TERMINAL PROJECT
 LOCATION PLAN &
 EXISTING FACILITY
 DRAWING NUMBER: 1861M-188-D-1001-00



**RAS ISSA PENINSULA
DETAIL "A"**

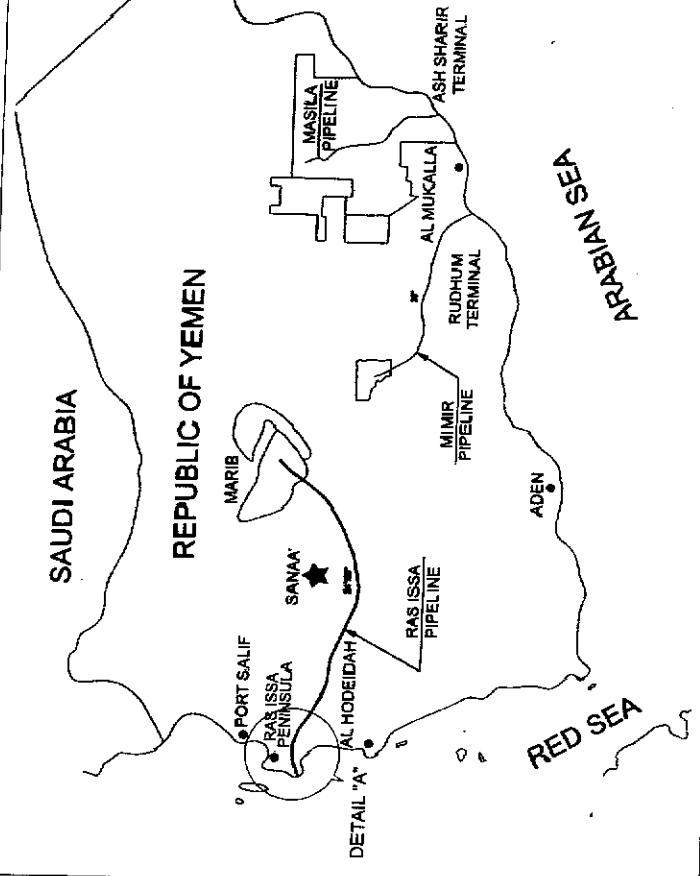

KEY PLAN

DRAWING NO.	REFERENCE DRAWINGS	REV DATE		DESCRIPTION	SCALE		NO SCALE		
		0	1		DATE	DATE	DATE	DATE	
				11/02/09	ISSUED FOR APPROVAL	DATE	21/07/09	DATE	21/07/09
				11/07/09	ISSUED FOR APPROVAL	DATE	21/07/09	DATE	21/07/09

BY	CHK	APP	OWN

NO	DATE	REVISION

E	N
d'	245469 1681692
b'	244730 1681044
c'	244605 1681450
d'	244839 1682220
e'	245454 1682128
f'	245895 1682069
g'	246028 1682052
h'	246150 1682001
i'	246717 1681473
j'	247050 1681165
k'	246603 1680499
l'	247516 1680474
m'	247550 1680474
n'	247961 1680517
o'	248738 1681279
p'	248856 1681482
q'	248076 1682639
r'	246093 1682065
s'	246282 1681964
t'	246385 1682162

PROJECT SITE CO - ORDINATES	
E	N
a	247300 1682500
b	247350 1681640
c	248300 1682300
q'	248076 1682639

SAFER Safar Exploration and Production Operations Company (SEPOC)

ENGINEERING AND CONSTRUCTION DEPT

RAS ISSA CRUDE OIL TERMINAL PROJECT

LOCATION PLAN FOR ONSHORE & OFFSHORE

DATE: 11/07/08
 DRAWN BY: []
 CHECKED BY: []
 APPROVED BY: []
 OWNER: []

1:361M-188-D-1002-00

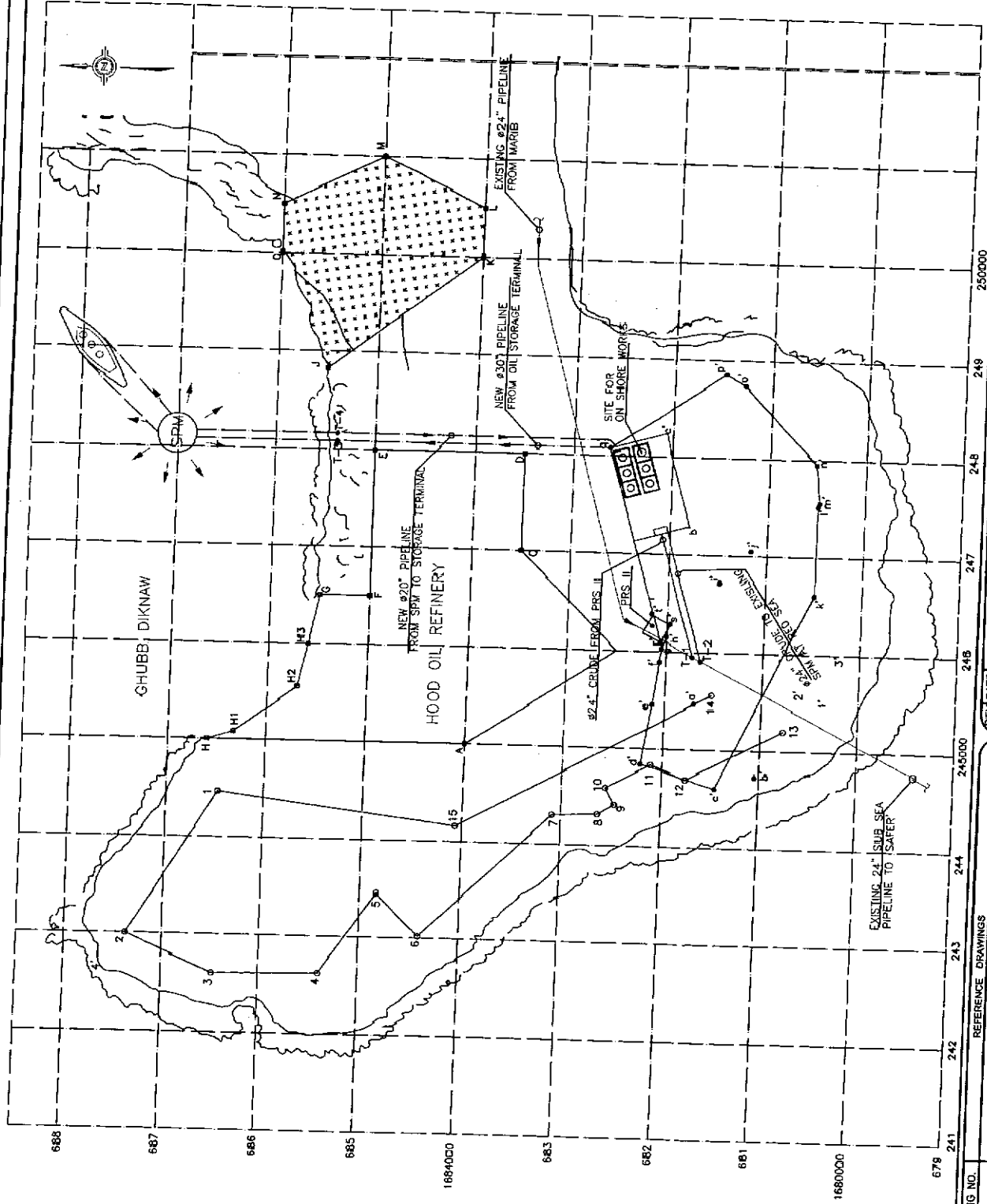

DRAWING NO.	REFERENCE DRAWINGS
REV. DATE	DESCRIPTION
0 11/07/08	ISSUED FOR APPROVAL
1 21/07/08	ISSUED FOR APPROVAL
BY CRK APPROV	
SCALE:	NO SCALE
DRAWN BY:	ALZAB
CHECKED BY:	ALZAB
APPROVED BY:	ALZAB
OWNER:	SAFER

SAFER Exploration and Production
 Safar Exploration and Production
 Operators Company (SAEPOC)

شركة سافر استكشاف وإنتاج
 Safar Exploration and Production
 Operators Company (SAEPOC)

ENGINEERING AND CONSTRUCTION DEPT
 RAS ISSA CRUDE OIL TERMINAL PROJECT
 GHUBB - DIKNAW BAY
 HYDROGRAPHIC LOCATION

DRAWING NUMBER: 1361M-188-D-1003
 SHEET NO. OF 00

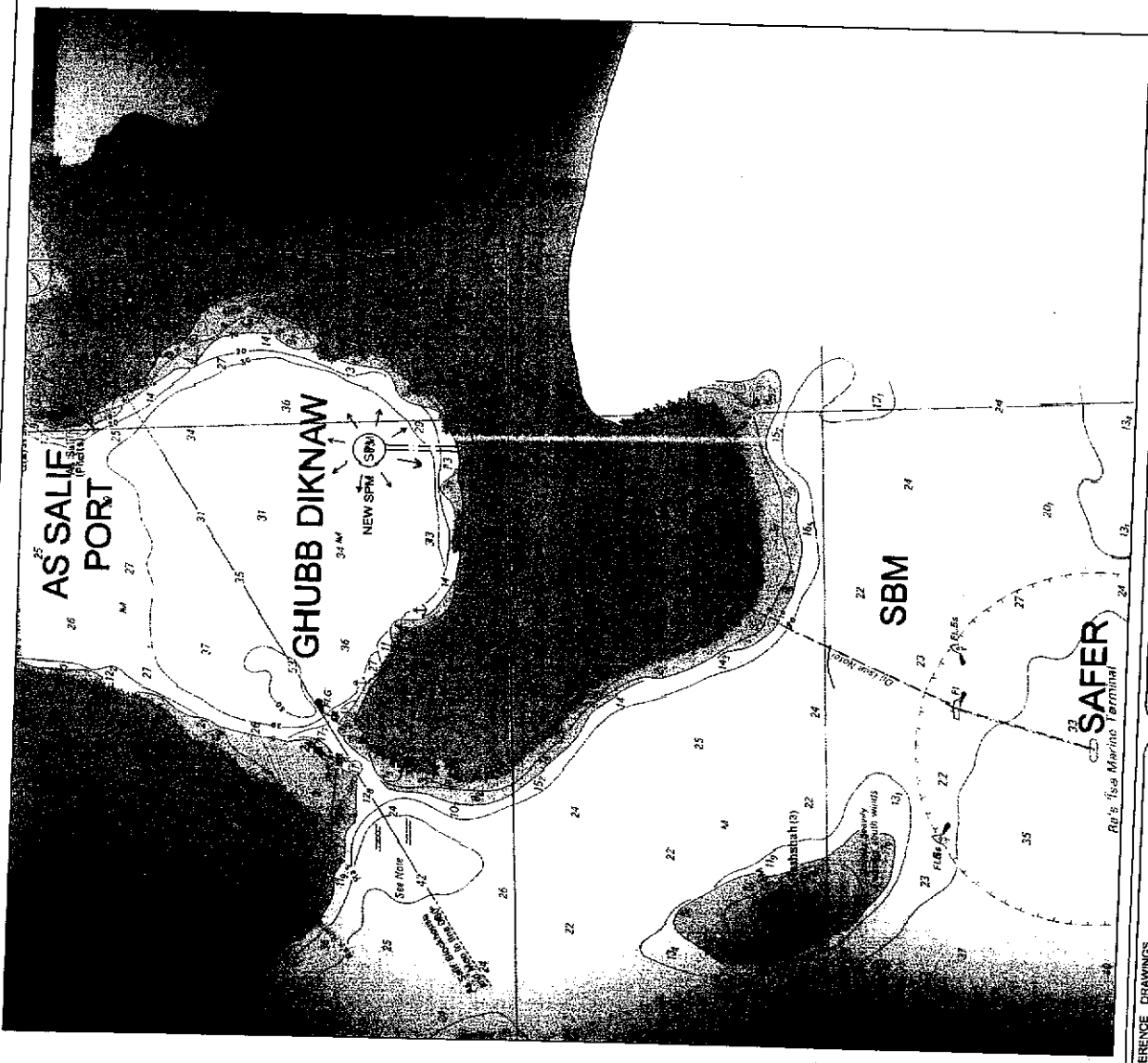

SCALE:	NO SCALE
OWNER	DATE
ENGINEER	DATE
APPROVER	DATE
OWNER	DATE

BY	CHK	APPROV

REV	DATE	DESCRIPTION
0	11/07/09	ISSUED FOR APPROVAL
1	21/07/09	ISSUED FOR APPROVAL

DRAWING NO.	REFERENCE DRAWINGS

A	245000	1684000
B	246000	1682500
C	247000	1681000
D	248000	1679500
E	249000	1678000
F	248500	1685000
G	246500	1685000
H	245000	1686000
H1	245080	1686330
H3	246000	1685600
J	248820	1685500
K	250000	1684000
L	250300	1684000
M	251000	1685000
N	250500	1686000
O	250000	1686000

1	244464	1686473
2	242997	1687371
3	242806	1688481
4	242824	1685397
5	243465	1684833
6	243018	1684407
7	244288	1683094
8	244317	1682631
9	244418	1682463
10	244591	1682557
11	244833	1682119
12	244694	1681749
13	245205	1680768
14	245563	1681515
15	244137	1684069

a	245469	1681892
b	244730	1681044
c	244605	1681450
d	244839	1682220
e	245454	1682128
f	245895	1682069
g	246028	1682052
h	246150	1682001
i	246717	1681473
j	247050	1681165
k	246603	1680499
l	247516	1680489
m	247550	1680474
n	247951	1680517
o	248738	1681279
p	248856	1681482
q	248076	1682639
r	248093	1682085
s	248282	1681984
t	246385	1682162

E	N
a	247300 1682500
b	247350 1681840
c	248300 1682300
q	248076 1682639

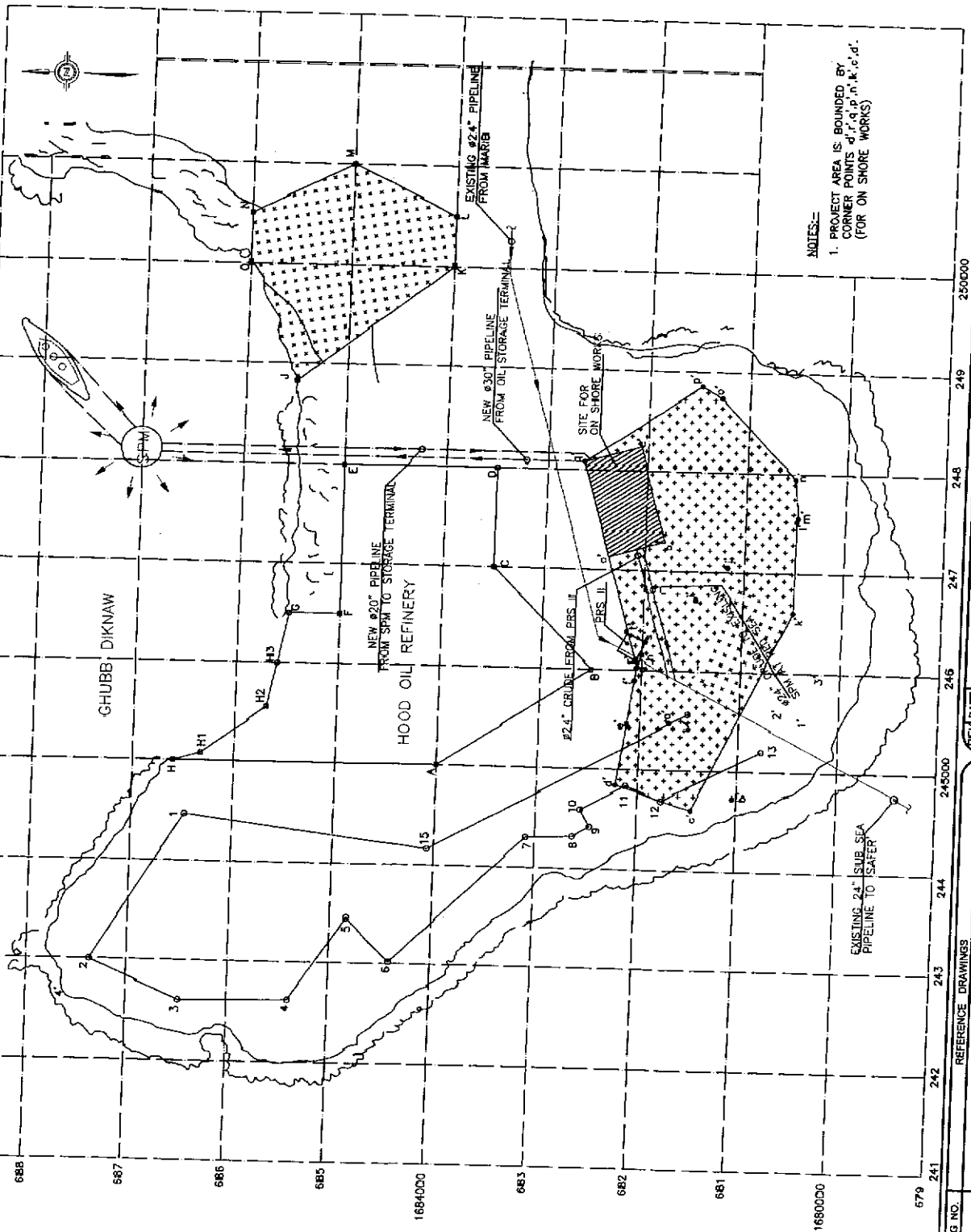

NOTES:-
1. PROJECT AREA IS BOUNDED BY CORNER POINTS 'a' through 't' (FOR ON SHORE WORKS)



SAFER Exploration and production
 Safety Operations Company (SEPOC)
 ENGINEERING AND CONSTRUCTION DEPT.
 BAS ISSA CRUDE OIL TERMINAL PROJECT
 LOCATION OF ONSHORE WORKS
 DRAWING NO. 1361M-188-D-1004-00

DRAWING NO.	1361M-188-D-1004-00
REV DATE	0 11/01/06 ISSUED FOR APPROVAL 1 21/07/06 ISSUED FOR APPROVAL
BY	CHK APPRVD
SCALE	NO SCALE
DRAWN BY	DATE: 21/07/06
CHECKED BY	DATE: 21/07/06
OWNER	DATE: 21/07/06
DESCRIPTION	REFERENCE DRAWINGS

245000

247000

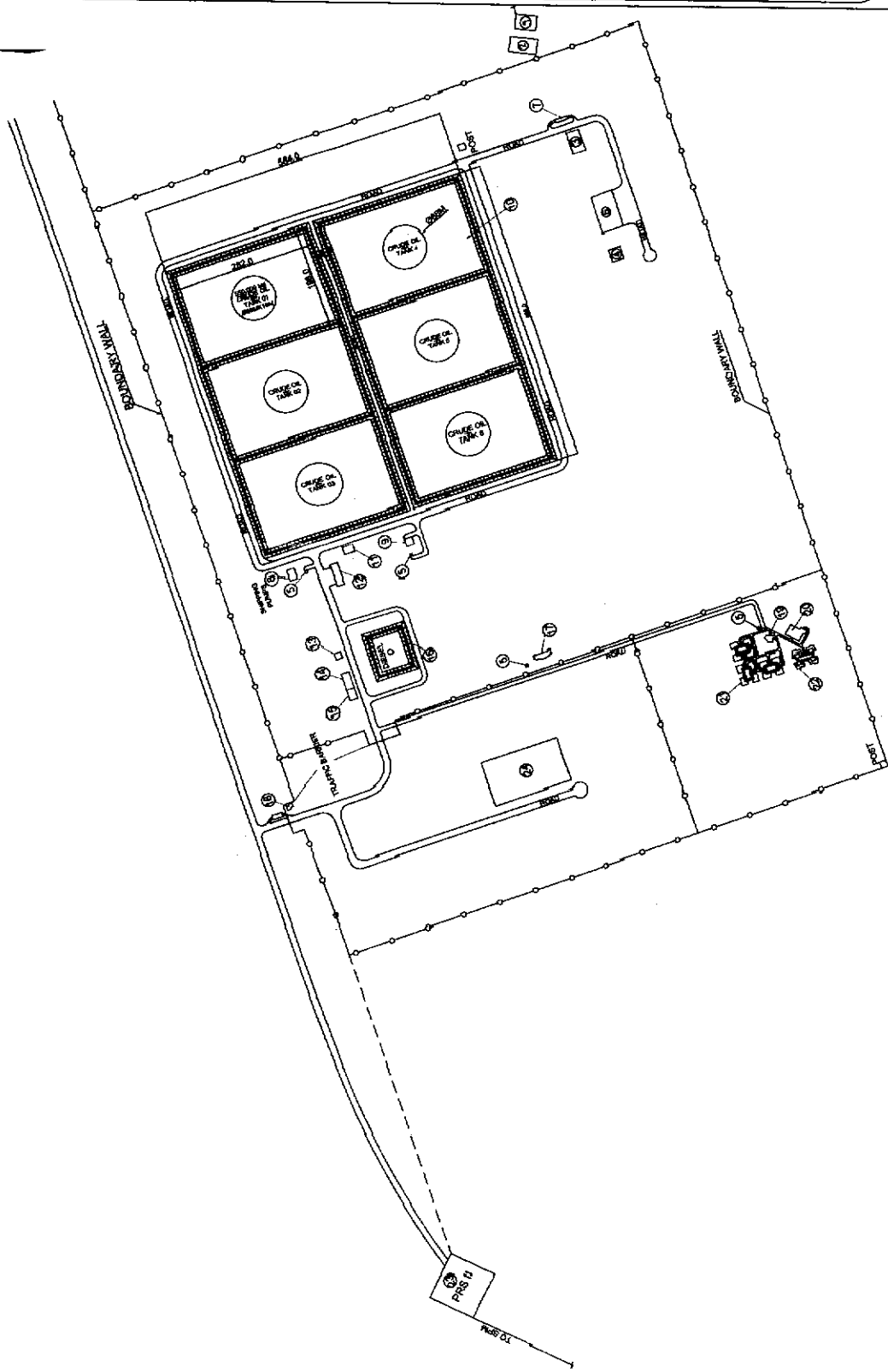
248000



LEGEND:

THE PLAN SHOWS ONLY CONCEPTUAL DESIGN IT IS EPC CONTRACTORS RESPONSIBILITY TO ADD, ALTER, MODIFY THE PLAN, DESIGN AND TO CARRY OUT 'ENGINEERING DESIGN', VERIFY PARAMETERS GIVEN IN DRAWING AND MAKE NECESSARY MODIFICATIONS AND ALSO ASSES THESE PARAMETERS WHICH ARE NOT GIVEN ON THE DESIGN.

- ① SEA WATER INTAKE (FOR R.O. & FIRE)
- ② SEA WATER PUMPS (FOR R.O. & FIRE)
- ③ R.O. PLANT (FOR SEA WATER STORAGE TANK & FRESH FRESH WATER STORAGE)
- ④ OILY WATER COLLECTION PIT & DISPOSAL ARRANGEMENT
- ⑤ SUBSTATION BUILDING
- ⑥ POWER PLANT & SUBSTATION
- ⑦ HOSE PIPE WAREHOUSE
- ⑧ SHIPPING PUMP STATION
- ⑨ BOOSTER PUMP STATION
- ⑩ CRUD OIL STORAGE YARD
- ⑪ OPERATIONAL CONTROL ROOM
- ⑫ FIRE STATION
- ⑬ LABORATORY
- ⑭ WAREHOUSE
- ⑮ WORK SHOP
- ⑯ DIESEL FUEL STORAGE YARD
- ⑰ ADMIN. BUILDING
- ⑱ GUARD ROOM
- ⑲ PRAYER HALL
- ⑳ MESS AND RECREATION BUILDING
- ㉑ RESIDENTIAL BUILDINGS FOR STAFF (12 BLOCKS)
- ㉒ EACH BLOCK FOR TWO (2) STAFF MEMBERS
- ㉓ RESIDENTIAL BUILDINGS FOR OFFICERS (4 BLOCKS)
- ㉔ EACH BLOCK FOR THREE (3) OFFICERS
- ㉕ EXISTING PRESSURE REDUCING STATION II (PRS II)
- ㉖ TRUCK LOADING GANTRY



ENGINEERING AND CONSTRUCTION DEPT

RAS ISSA CRUDE OIL TERMINAL PROJECT

MASTER PLAN FOR THE ON SHORE TERMINAL

DATE: 1361M - 18B - D - 1005 00 0

SCALE:		NO SCALE	
DRAWN	CHKD	DATE	DATE

REV	DATE	DESCRIPTION
0	11/05/08	ISSUED FOR APPROVAL
0	11/05/08	ISSUED FOR APPROVAL

DRAWING NO.	REFERENCE	DRAWINGS

BY CHK APPROVAL

DESCRIPTION

REV DATE DESCRIPTION

DRAWING NO. REFERENCE DRAWINGS